

# SR 1015 OVER UNNAMED TRIBUTARY TO MARTINS CREEK BRIDGE PROJECT

## Lower Mount Bethel Township, Northampton County

### BRIDGE FEATURES:

- BUILT IN 1918  
(REINFORCED CONCRETE SLAB)
- BRIDGE IS IN FAIR CONDITION

### PURPOSE:

- REPLACE THE EXISTING BRIDGE IN A WAY THAT WILL MAINTAIN THE EXISTING CROSSING, MEET CURRENT DESIGN STANDARDS, AND MINIMIZE THE IMPACTS DURING CONSTRUCTION.

### ANTICIPATED PROJECT SCHEDULE:

(SUBJECT TO CHANGE)

- PRELIMINARY AND FINAL ENGINEERING  
(PRESENT TO SPRING 2026)
- AWARD CONTRACT  
(FALL 2026)
- CONSTRUCTION  
(SPRING 2027 TO WINTER 2028)
- ANTICIPATED CONSTRUCTION  
DURATION - 3 MONTHS

TEMPORARY  
CONSTRUCTION  
EASEMENT

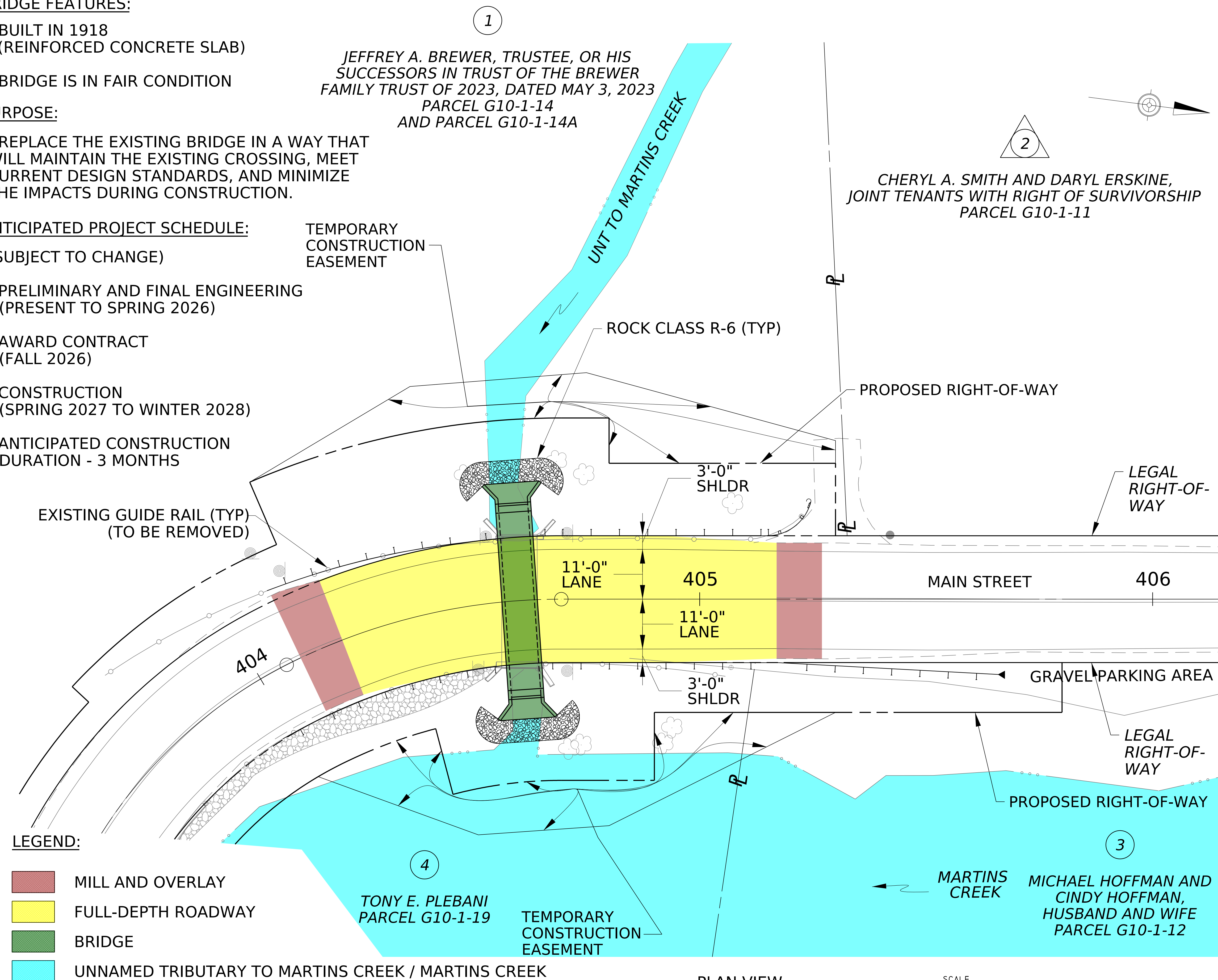

PLAN VIEW

SCALE  
0 10 20 FEET



ROADWAY VIEW FROM NORTHERN APPROACH



ROADWAY VIEW FROM SOUTHERN APPROACH



EAST ELEVATION VIEW

**PRELIMINARY**



# SR 1015 OVER UNNAMED TRIBUTARY TO MARTINS CREEK BRIDGE PROJECT

## Lower Mount Bethel Township, Northampton County

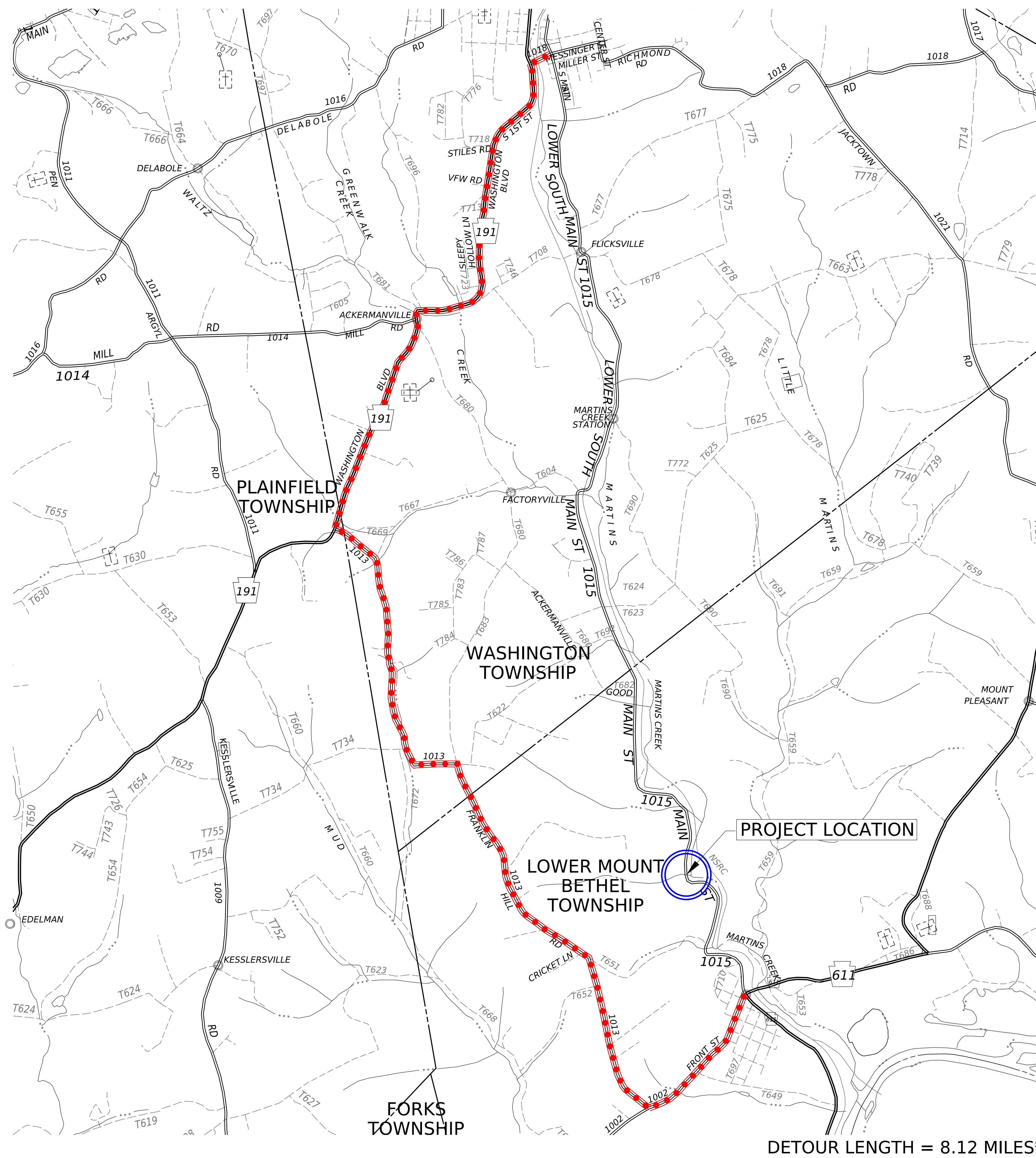

ROADWAY VIEW FROM SOUTH APPROACH



ROADWAY FROM SOUTH APPROACH

\*DETOUR MATCHES SR 1015-03B  
PROJECT, CONSTRUCTION 2023-2024

**PRELIMINARY**