

SR 209 OVER UNNAMED TRIBUTARY TO SCHUYLKILL RIVER BRIDGE PROJECT

Blythe Township, Schuylkill County

BRIDGE FEATURES:

- BUILT IN 1917 (REINFORCED CONCRETE SLAB)
- WIDENED IN 1949
- BRIDGE IS IN POOR CONDITION

PURPOSE:

- REPLACE THE EXISTING BRIDGE IN A WAY THAT WILL MAINTAIN THE EXISTING CROSSING, MEETS CURRENT DESIGN STANDARDS, AND MINIMIZES THE IMPACTS DURING CONSTRUCTION.



EAGLE HILL ROAD



RIDGE ROAD



ADJACENT PARKING LOT

PROJECT SCHEDULE:

- PRELIMINARY AND FINAL ENGINEERING (PRESENT TO FALL 2026)
- AWARD CONTRACT (FALL/WINTER 2026)
- CONSTRUCTION (SPRING 2027 TO FALL/WINTER 2027)

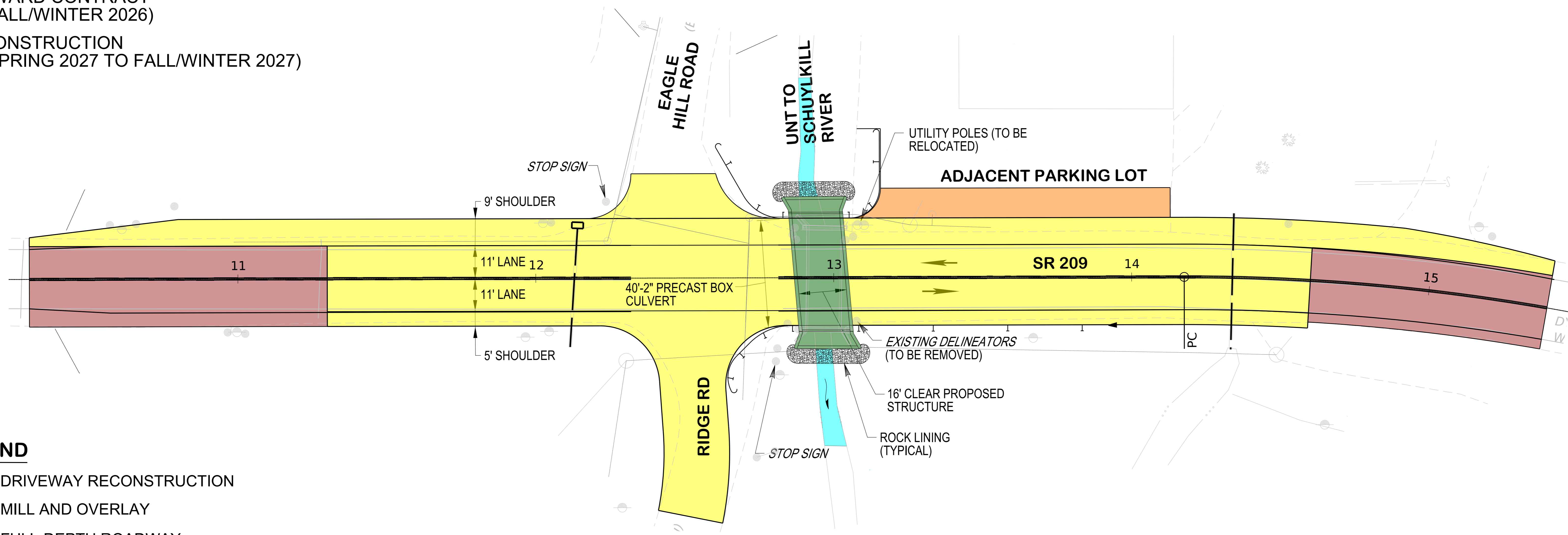

LEGEND

- DRIVEWAY RECONSTRUCTION
- MILL AND OVERLAY
- FULL-DEPTH ROADWAY
- BRIDGE
- UNT TO SCHUYLKILL RIVER

PRELIMINARY

SR 209 OVER UNNAMED TRIBUTARY TO SCHUYLKILL RIVER BRIDGE PROJECT

Blythe Township, Schuylkill County

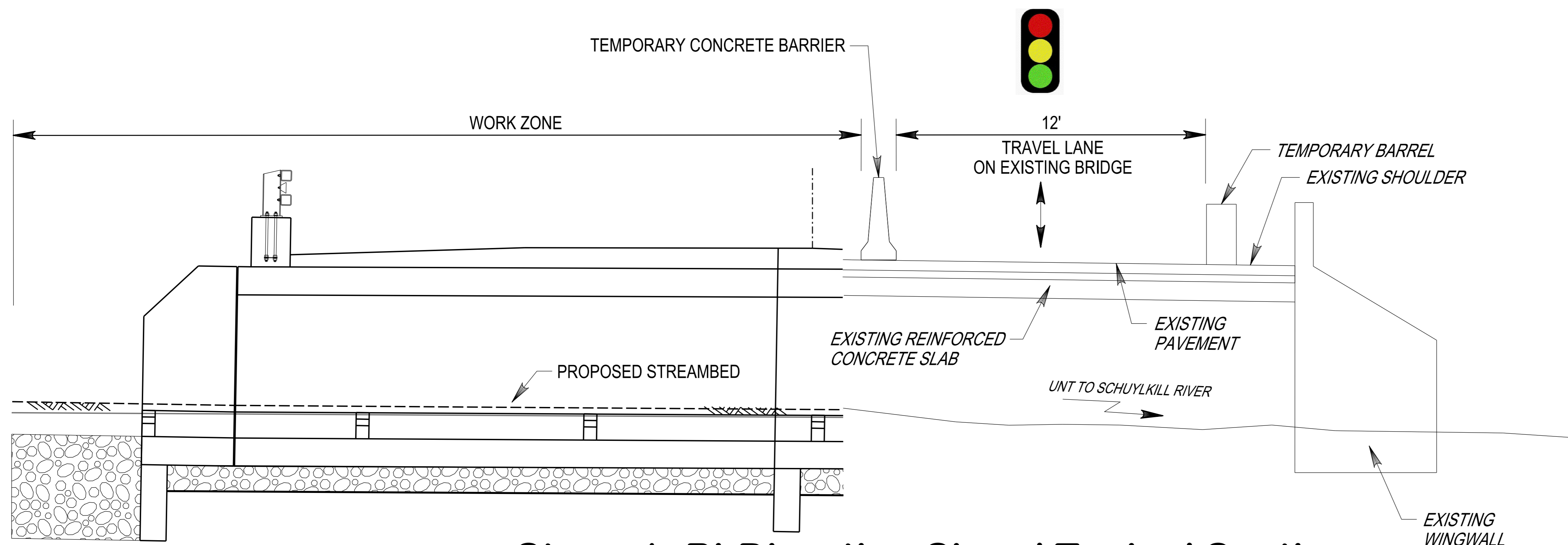

Stage 1- Bi-Direction Signal Typical Section

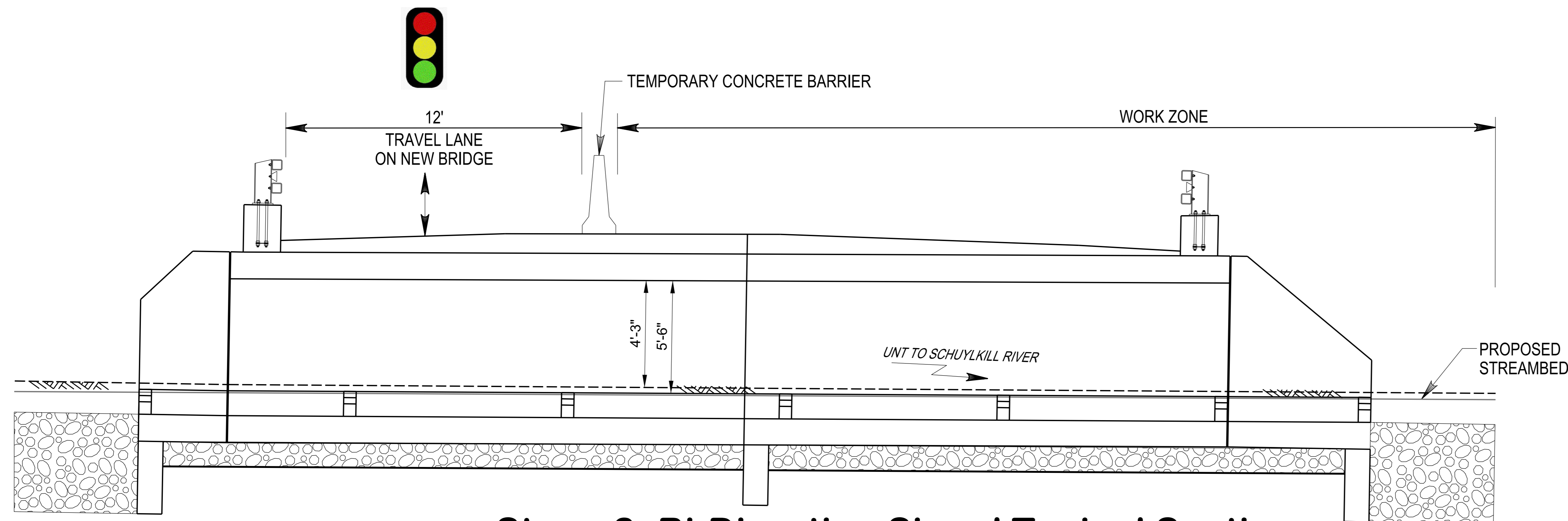

Stage 2- Bi-Direction Signal Typical Section



TYPICAL ROADWAY VIEW

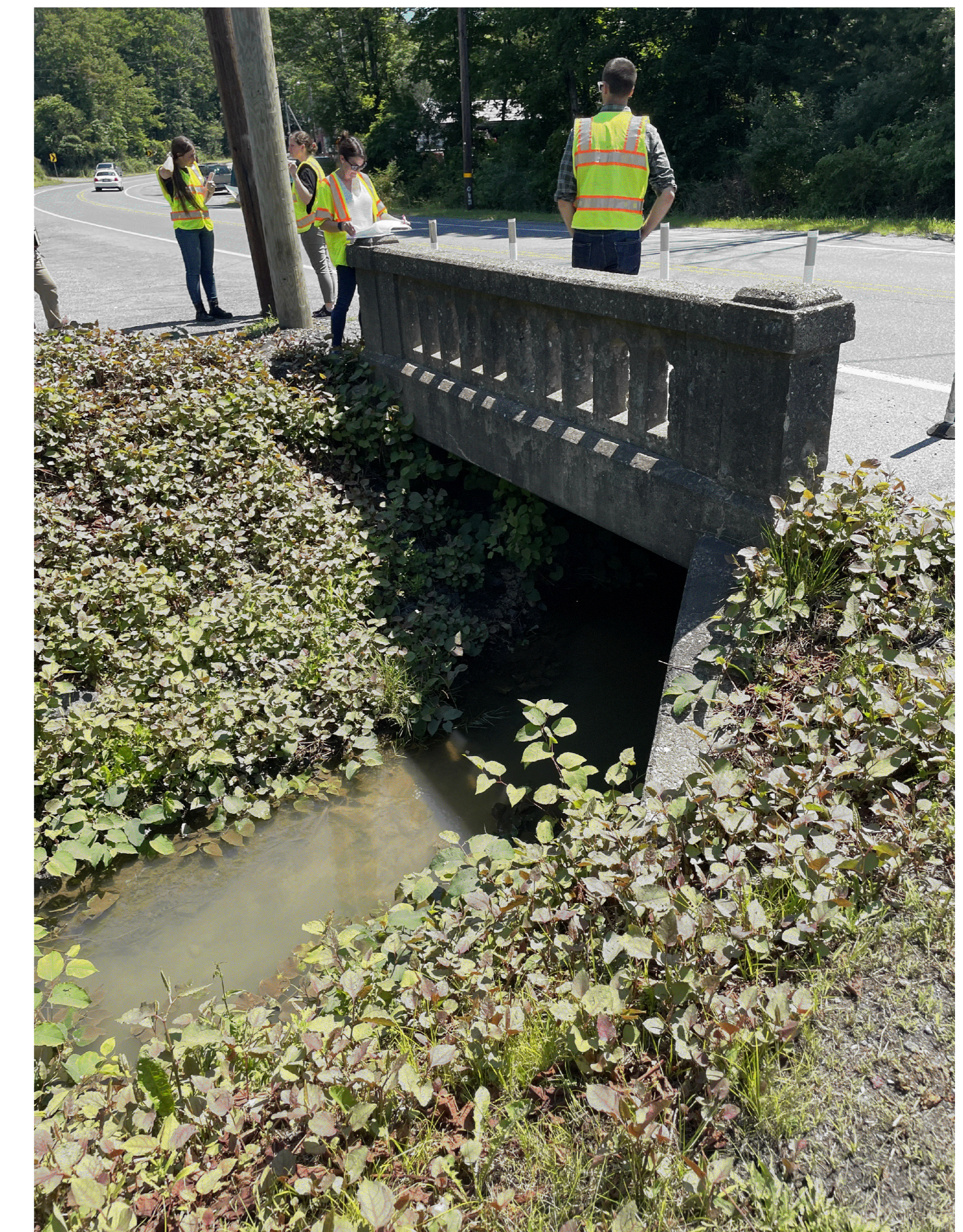

TYPICAL ELEVATION VIEW

PRELIMINARY