

PERKIOMENVILLE ROAD BRIDGE OVER SCIOTO CREEK REPLACEMENT PROJECT



AUGUST 2024

MEETING AGENDA

Project Location

Project Purpose and Need

Existing Bridge Description

Environmental Resources

Project Improvements

Traffic Control

Project Schedule

Questions



PROJECT LOCATION

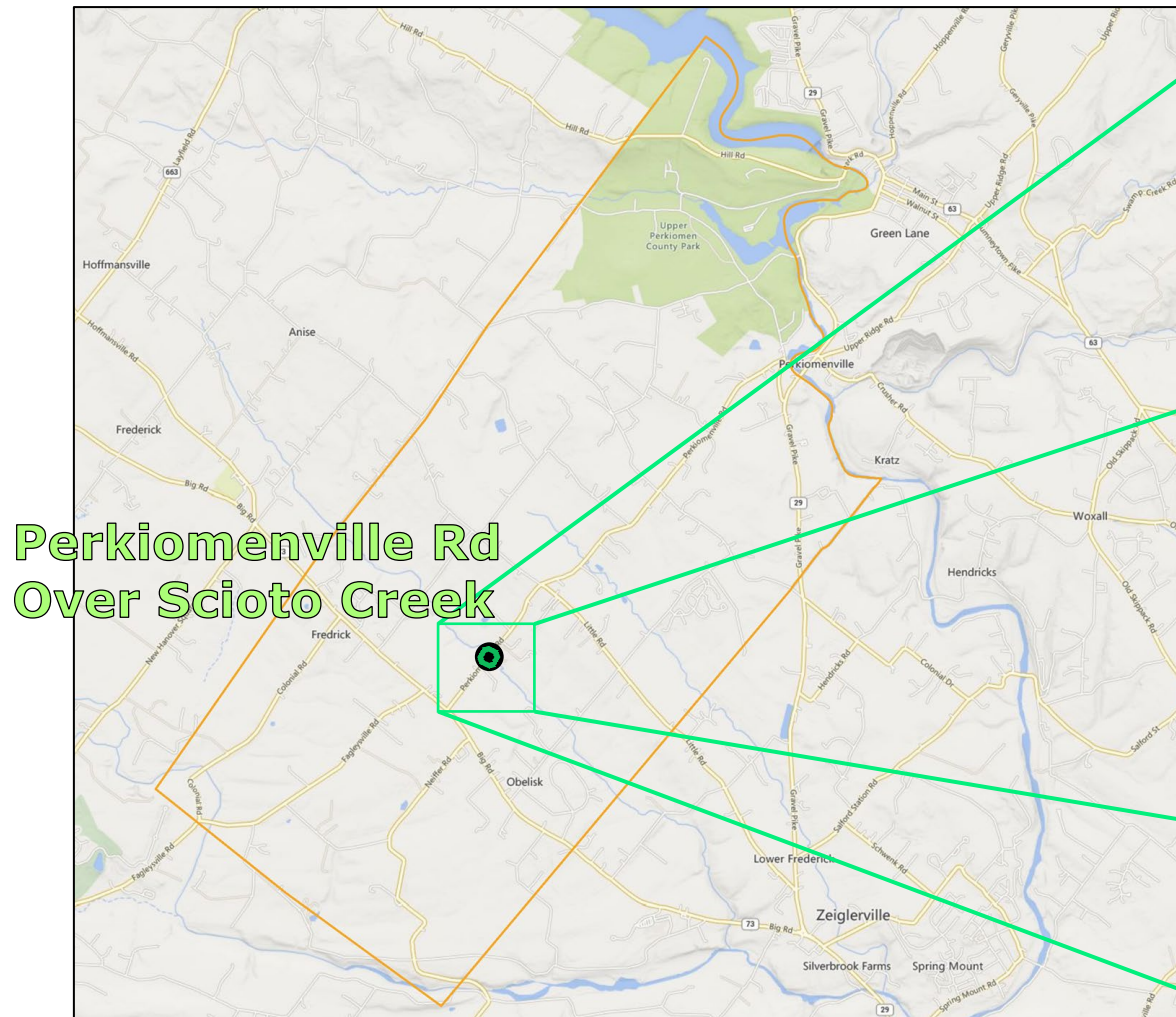

PROJECT PURPOSE



The purpose of this project is to provide a structure that is capable of efficiently and safely handling the existing and expected traffic on Perkiomenville Road while maintaining an approved hydraulic opening for Scioto Creek.



PROJECT NEED

- The bridge is in overall poor condition
- The bridge is posted with weight restrictions



Overview of concrete arch on downstream side of bridge



Underside of arch looking northeast



Underside of arch looking southwest



EXISTING BRIDGE DESCRIPTION

The existing bridge carries two 10' wide lanes with 4' wide shoulders.



- Reinforced concrete arch
- Structure mounted guiderail
- 28' span
- Inside curb-to-curb width of 28'
- Built in 1932
- 1,520 vehicles use the bridge each day
- 36-ton weight restriction (40-ton combination)

ENVIRONMENTAL RESOURCES



812 Perkiomenville Road
Philip Groob House
-Recommended not
eligible for National
Register of Historic Places



855 Perkiomenville Rd
Conrad Grubb Homestead
-Listed on National
Register of Historic Places



Perkiomenville Road Bridge
over Scioto Creek
-Not eligible for National
Register of Historic Places



ENVIRONMENTAL RESOURCES



ENVIRONMENTAL RESOURCES

The project is within a detailed FEMA study area.

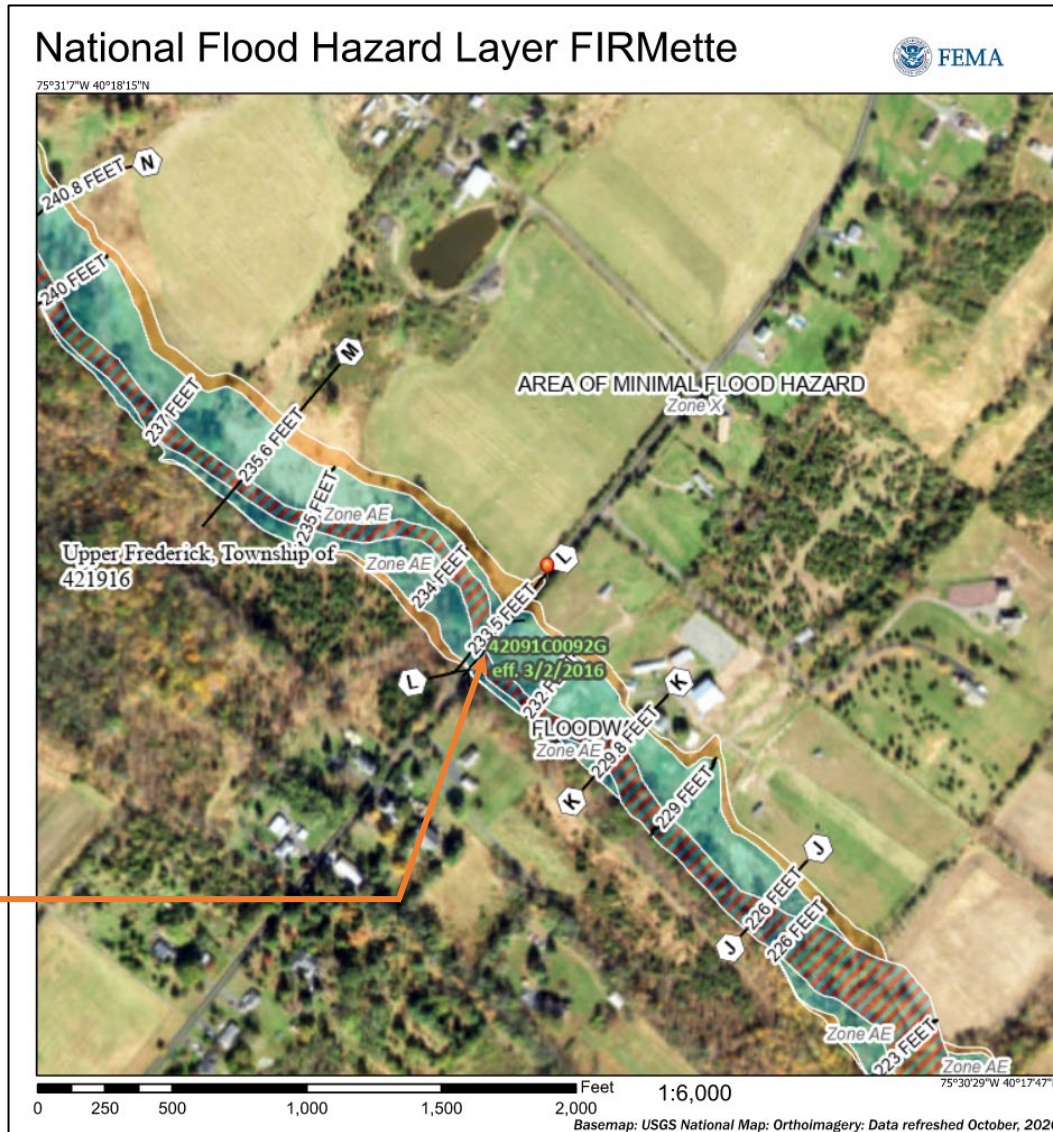

Project Site

Legend

SEE FIS REPORT FOR DETAILED LEGEND AND INDEX MAP FOR FIRM PANEL LAYOUT

SPECIAL FLOOD HAZARD AREAS		Without Base Flood Elevation (BFE) Zone A, V, A99
		With BFE or Depth Zone AE, AO, AH, VE, AR
		Regulatory Floodway
OTHER AREAS OF FLOOD HAZARD		0.2% Annual Chance Flood Hazard, Areas of 1% annual chance flood with average depth less than one foot or with drainage areas of less than one square mile Zone X
		Future Conditions 1% Annual Chance Flood Hazard Zone X
		Area with Reduced Flood Risk due to Levee. See Notes. Zone X
		Area with Flood Risk due to Levee Zone D
OTHER AREAS		NO SCREEN Area of Minimal Flood Hazard Zone X
		Effective LOMRs
GENERAL STRUCTURES		Area of Undetermined Flood Hazard Zone D
		Channel, Culvert, or Storm Sewer
		Levee, Dike, or Floodwall
OTHER FEATURES		20.2 Cross Sections with 1% Annual Chance Water Surface Elevation
		17.5 Cross Sections with 1% Annual Chance Water Surface Elevation
		8 Coastal Transect
		Base Flood Elevation Line (BFE)
		Limit of Study
OTHER FEATURES		Jurisdiction Boundary
		Coastal Transect Baseline
		Profile Baseline
MAP PANELS		Digital Data Available
		No Digital Data Available
		Unmapped



ENVIRONMENTAL RESOURCES

- Pennsylvania Code Chapter 93
 - Scioto Creek is classified as a Trout Stocked Fishery and Migratory Fishery (TSF, MF)
- Pennsylvania Fish and Boat Commission
 - Scioto Creek is not classified as a Wild Trout Stream or an approved trout stocked stream.



ENVIRONMENTAL RESOURCES

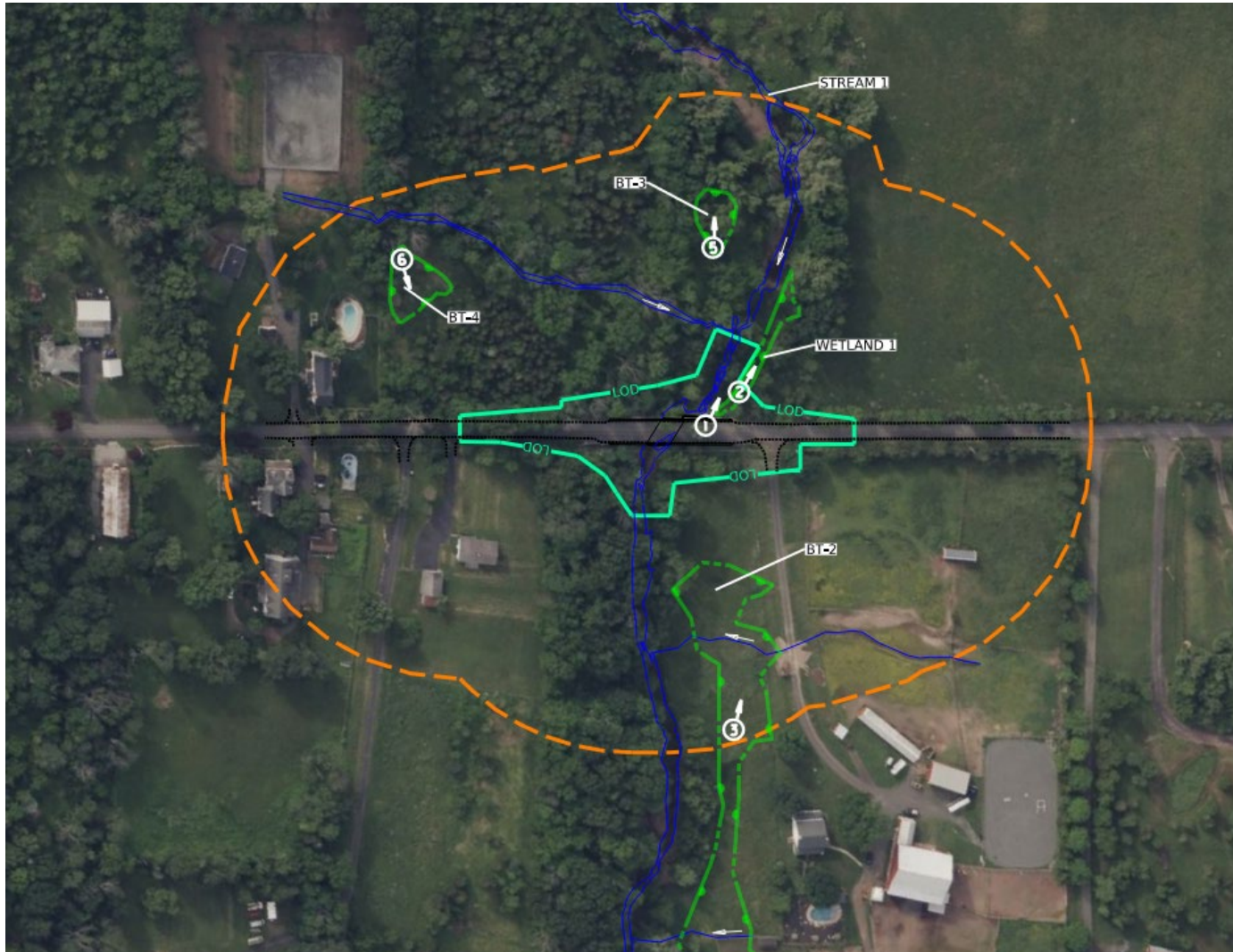

- Four wetlands were identified within 300' of the project site.
 - A Phase I Bog Turtle Habitat Survey found that a wetland South of the project met the criteria for a Bog Turtle habitat.
- One of the wetlands is within the project limits.





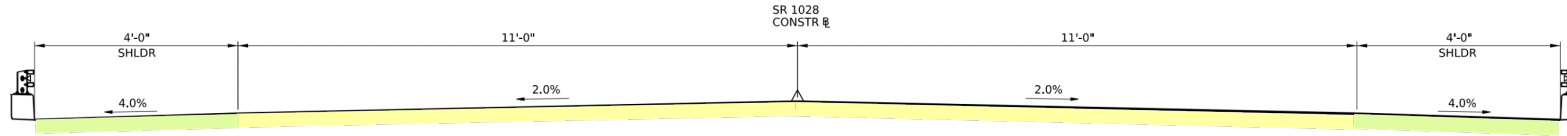

PROPOSED BRIDGE

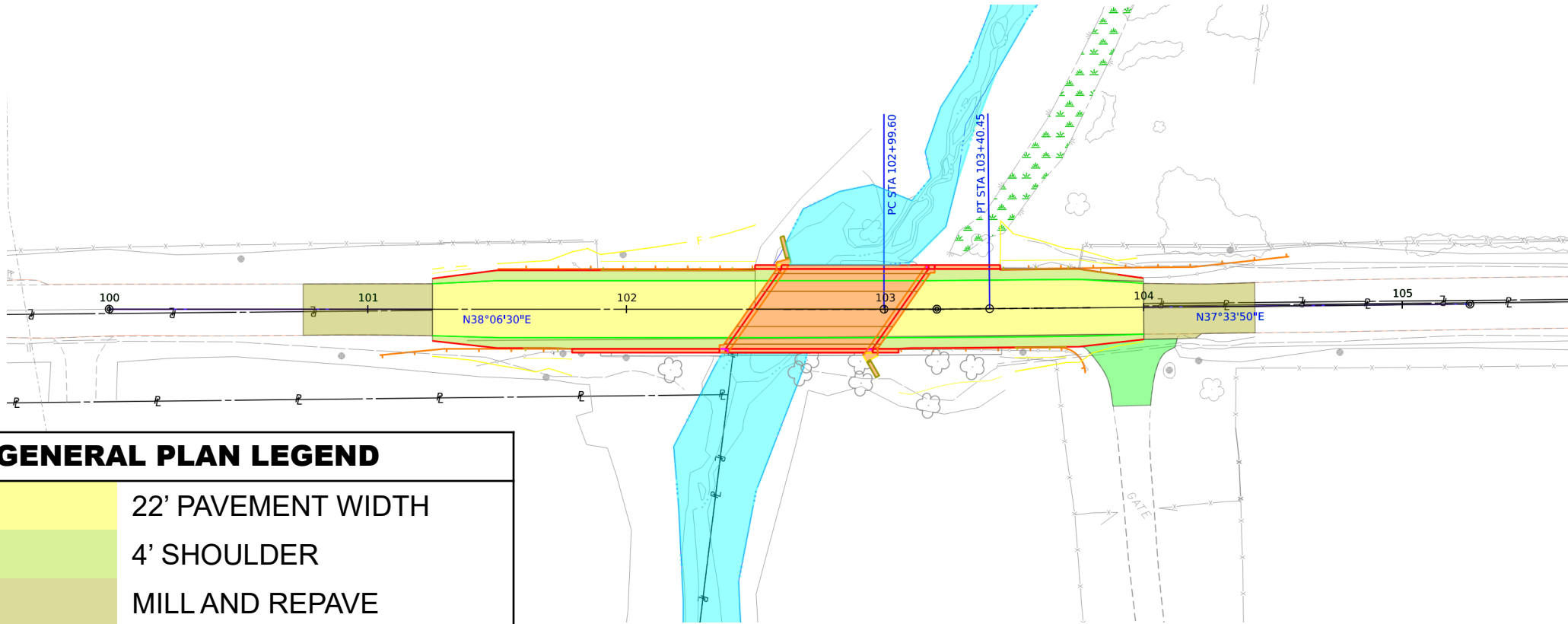

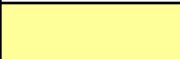
BRIDGE TYPICAL SECTION

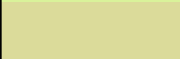

GENERAL PLAN LEGEND	
	22' PAVEMENT WIDTH
	4' SHOULDER
	MILL AND REPAVE
	PROPOSED STRUCTURE
	DRIVEWAY

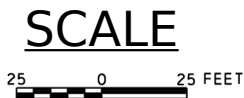

TRAFFIC CONTROL

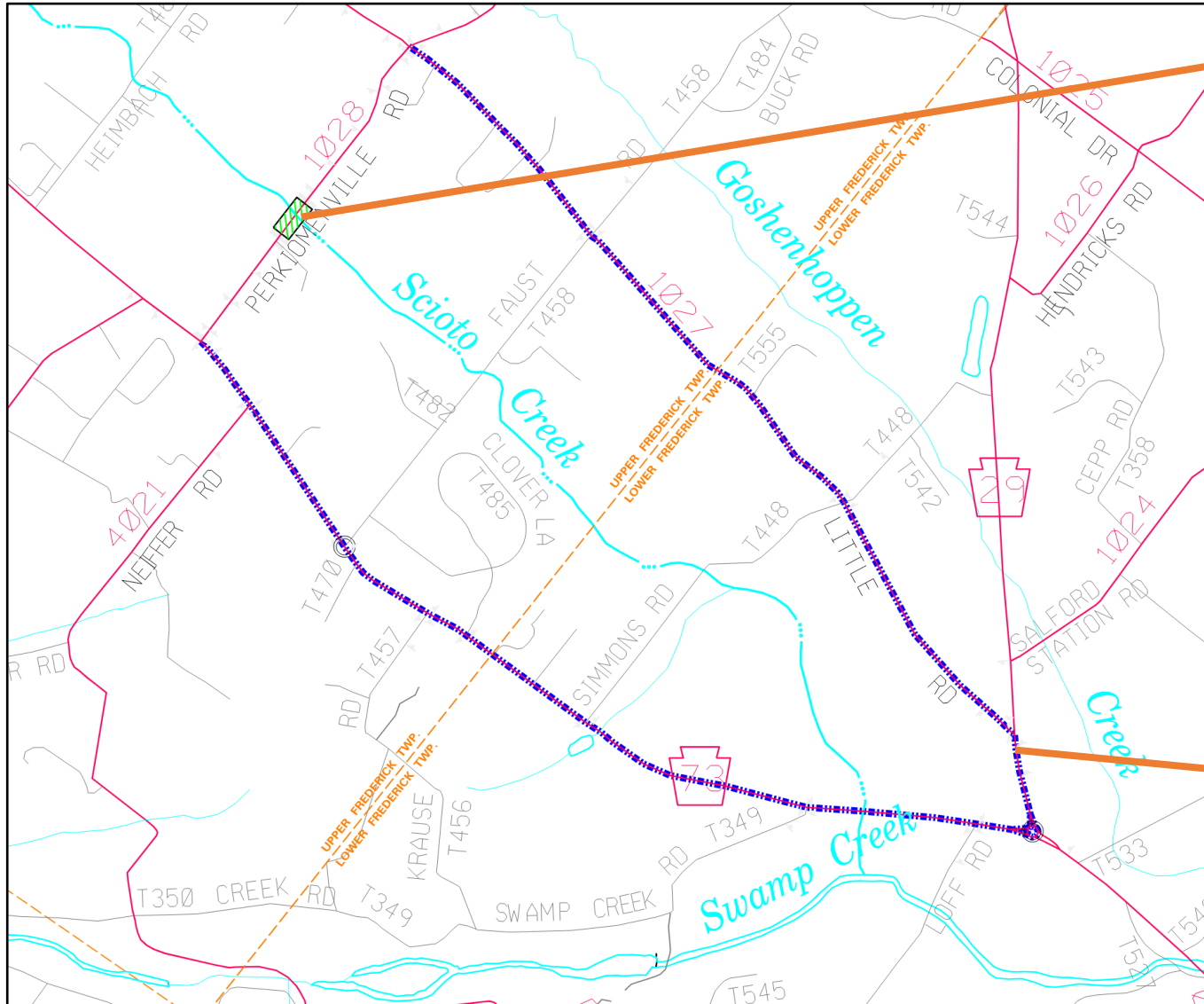

PROJECT LOCATION

Local traffic access will be maintained at all times.

LEGEND

- STREAM
- STATE ROUTE
- TOWNSHIP ROAD
- TOWNSHIP LINE
- PROJECT
- DETOUR ROUTE

DETOUR ROUTE
5.9 MILES



SCALE



TRAFFIC CONTROL

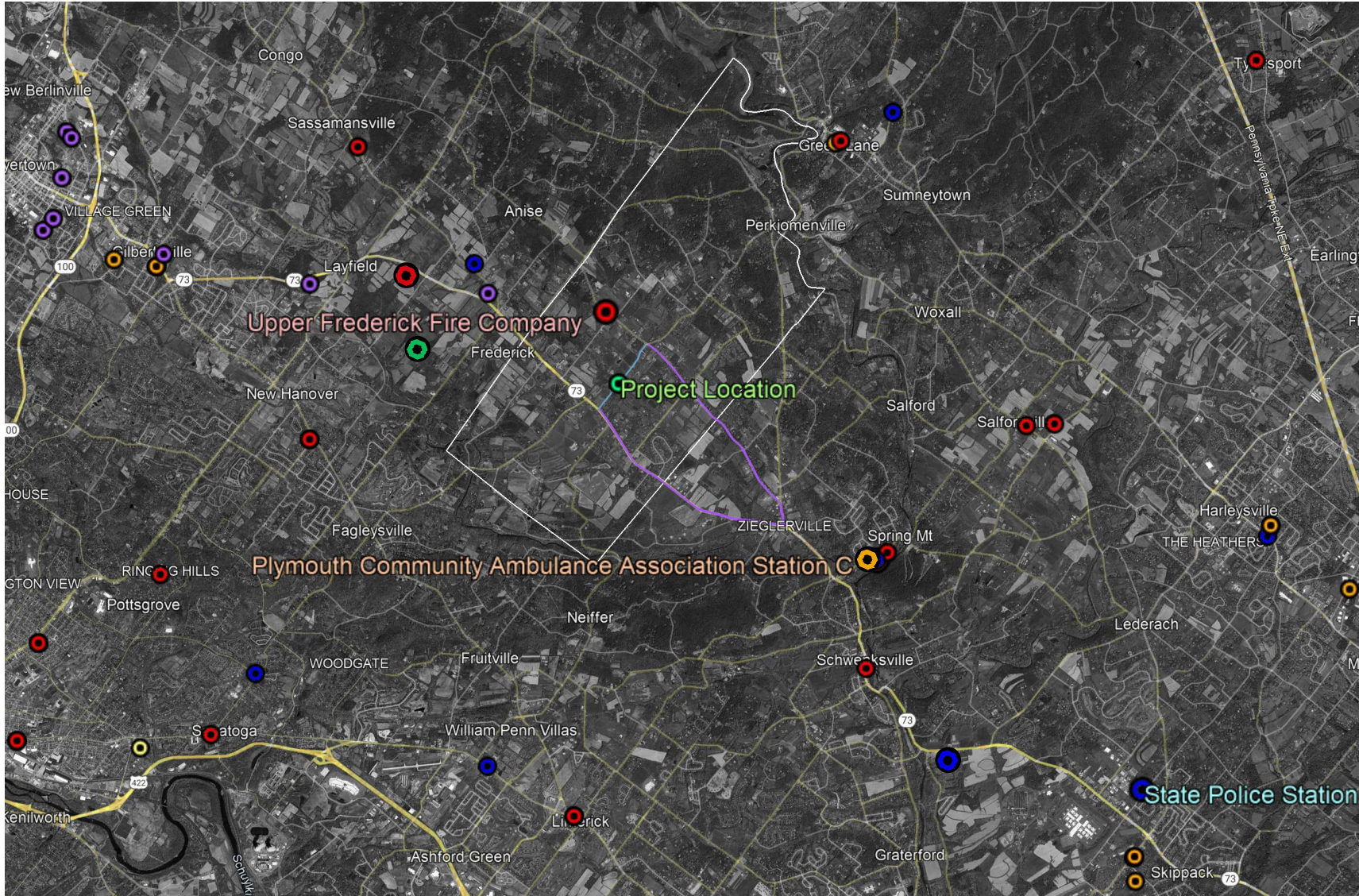

LEGEND

-  PROJECT LOCATION
-  SCHOOLS
-  FIRE STATIONS
-  EMS
-  POLICE STATIONS
-  DETOUR



SCALE



PROJECT SCHEDULE

	2024				2025				2026				2027			
Task	Q1	Q2	Q3	Q4	Q1	Q2	Q3	Q4	Q1	Q2	Q3	Q4	Q1	Q2	Q3	Q4
NEPA Studies			■	■	■											
Geotechnical Study				■	■	■										
Final Design						■	■									
Utility Conflict Resolution						■	■									
Section 404/105 Permitting						■	■									
ROW Acquisition						■	■									
Contracting								■	■							
Construction									■	■	■	■	■			





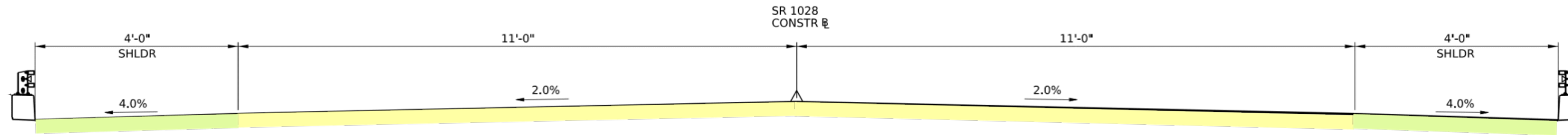

QUESTIONS?

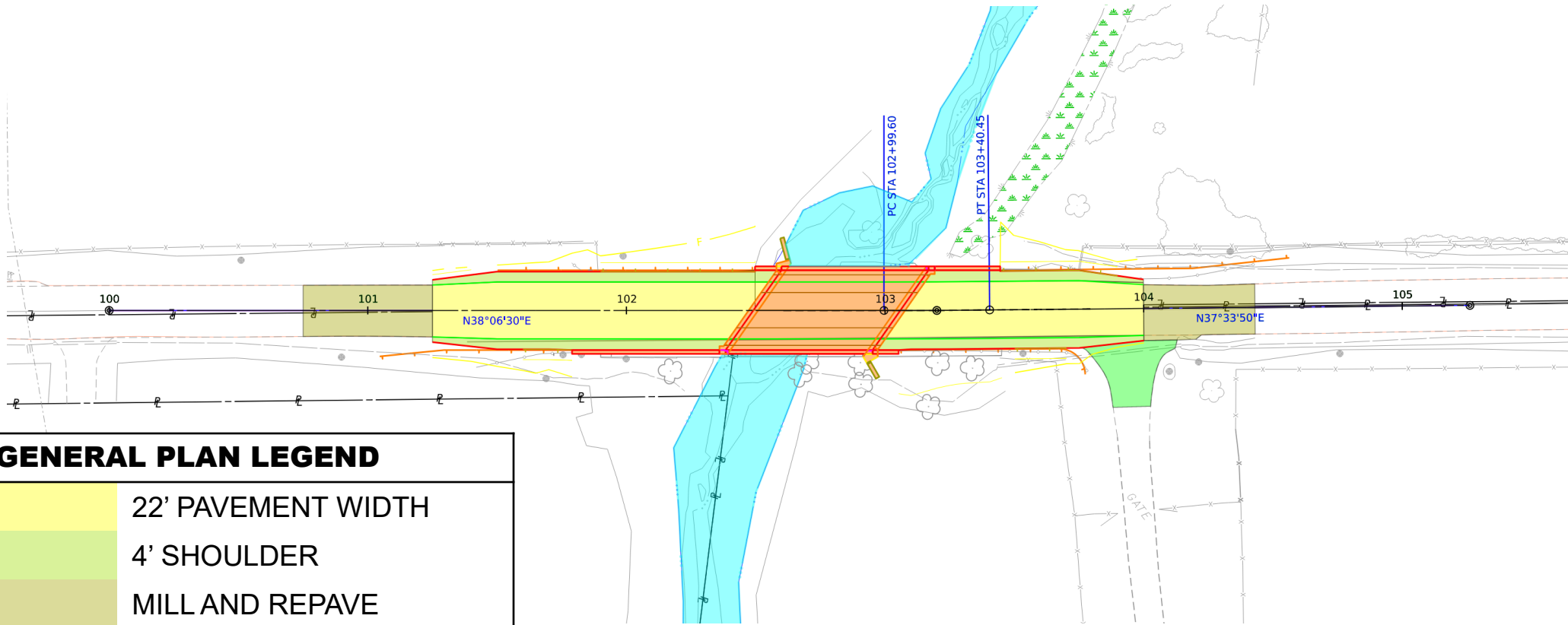

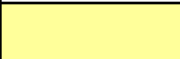
BRIDGE TYPICAL SECTION

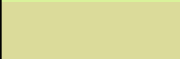

GENERAL PLAN LEGEND	
	22' PAVEMENT WIDTH
	4' SHOULDER
	MILL AND REPAVE
	PROPOSED STRUCTURE
	DRIVEWAY

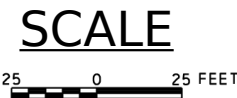

THANK YOU FOR PARTICIPATING!

FOR MORE INFORMATION, VISIT THE PENNDOT DISTRICT 6 WEBSITE

WWW.PENNDOT.PA.GOV/REGIONALOFFICES/DISTRICT-6

OR

EMAIL WESLEY OVENS, AT WOVENS@PA.GOV