

**SR 0422 E. CUMBERLAND STREET RESURFACING
NORTH LEBANON TOWNSHIP, SOUTH LEBANON
TOWNSHIP, JACKSON TOWNSHIP,
AND CITY OF LEBANON
LEBANON COUNTY, PENNSYLVANIA**

MPMS 105343

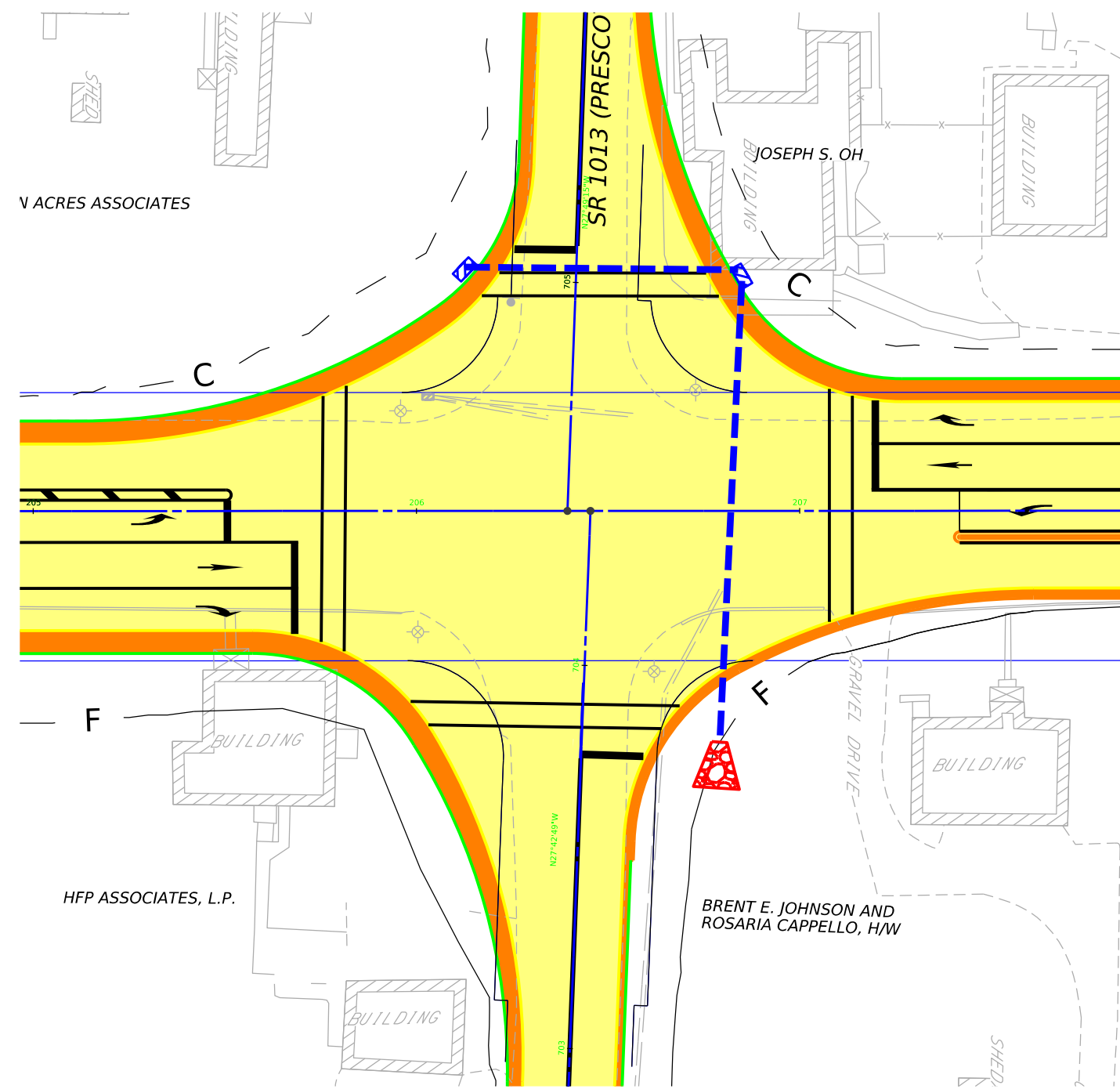

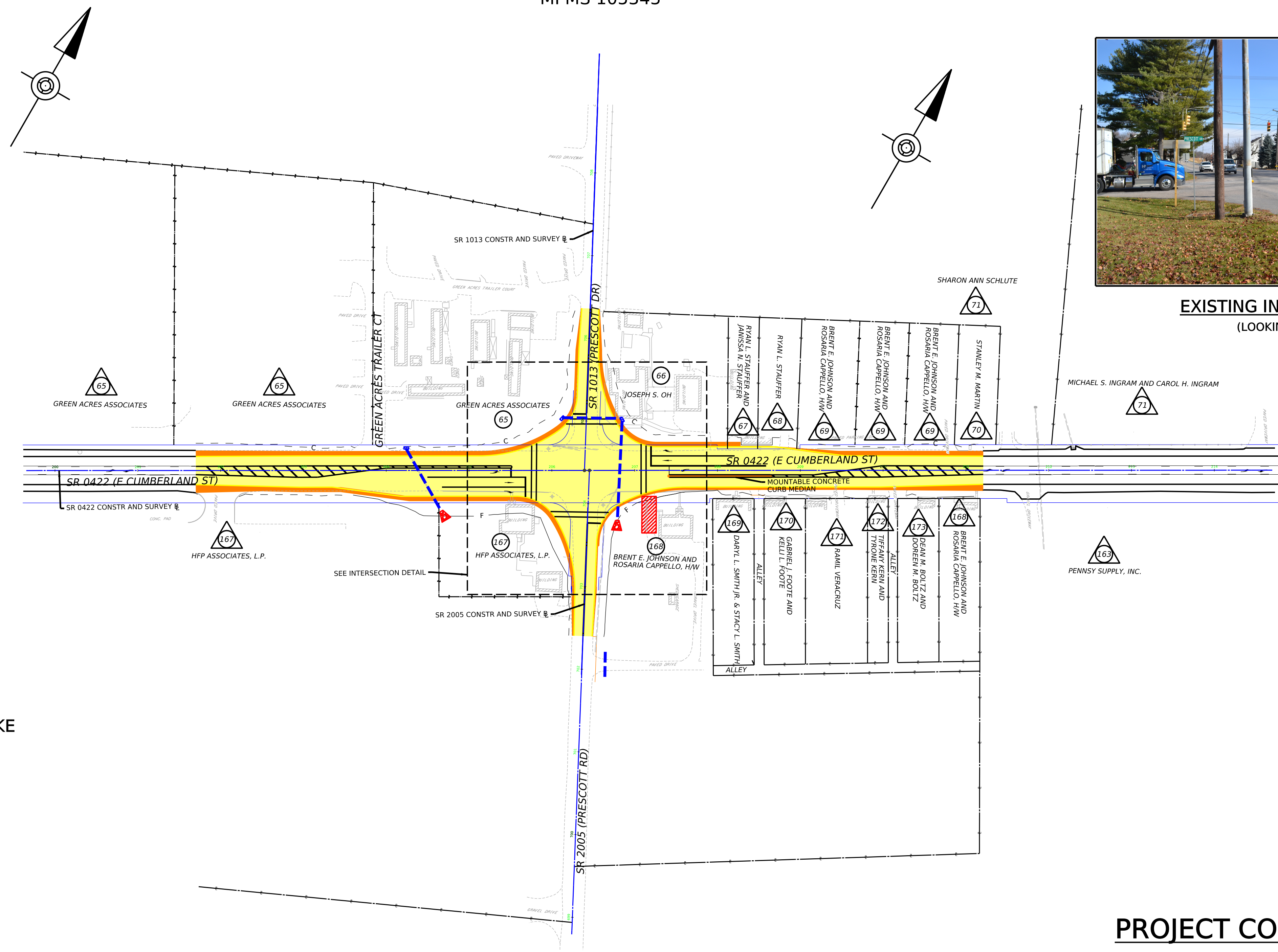







**INTERSECTION DETAIL
(NOT TO SCALE)**

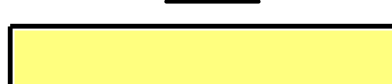

**EXISTING INTERSECTION
(LOOKING EAST)**

LEGEND

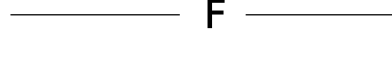
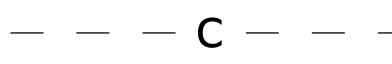
-  PARCEL IDENTIFICATION NUMBER
-  PARCEL IDENTIFICATION NUMBER NO TAKE
-  PROPOSED TRAVEL LANE
-  PROPOSED SHOULDER
-  DRIVEWAY TO BE REMOVED
-  PROPOSED DRAINAGE PIPE
-  PROPOSED PAVEMENT MARKING ARROW
-  PROPOSED TRAFFIC SIGNAL SUPPORTS
-  PROPOSED FILL LIMITS
-  PROPOSED CUT LIMITS
-  EXISTING RIGHT-OF-WAY

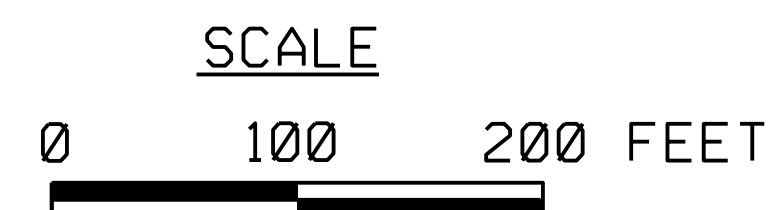

PROJECT CONTACT:

CHRIS M. MCKEE, PROJECT MANAGER
PENNDOT ENGINEERING DISTRICT 8-0
EMAIL: CHMCKEE@PA.GOV
PHONE: (717)-705-6179